

# CURRENT TRANSFORMERS

**Models:**  
0620RW, & 0623RW

Fully encapsulated.  
Indoor/outdoor applications.

Standard 5-amp secondary.  
Others available.

**APPLICATION:**  
With Wattmeters and Ammeters.

**CONTINUOUS THERMAL RATING:**  
1.33 at 30 C. amb.; 1.0 at 55 C. amb.

**INSULATION CLASS:**  
0.6 kV. BIL 10kV. full wave. 50-400 Hz.

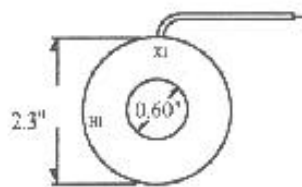
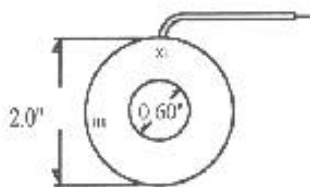
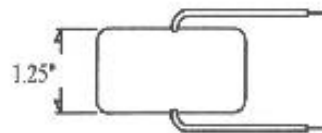
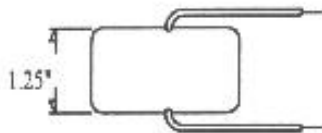
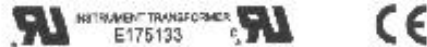

0620RW-\*\*

0623RW-\*\*

- Flexible leads are UL 3173 125 degree C. CSA approved, #16 AWG 24" long.
- Non-Standard length to be specified.
- Additional ratios available.
- Approximate weight 0.5 lb.

CATALOG NUMBER	CURRENT RATIO	ACCURACY AT 60 Hz	BURDEN VA at 60 Hz
**50	50:5	+2%	1.0
**60	60:5	+1%	2.0
**75	75:5	+1%	2.0
**80	80:5	+1%	2.0
**100	100:5	+1%	2.0
**120	120:5	+1%	2.5
**125	125:5	+1%	2.5
**150	150:5	+1%	4.0
**200	200:5	+1%	4.0
**250	250:5	+1%	6.0
**300	300:5	+1%	8.0

Similar to FET models 1A & 1B

Made in the United States of America

# CURRENT TRANSFORMERS

Window Diameter 3.7"

Models: 37603RW & SH

Fully encapsulated.  
Indoor/Outdoor applications.

Standard 5-amp secondary.  
Others available.

## APPLICATION:

Relay, Watthour meters, Wattmeters and Ammeters.

## CONTINUOUS THERMAL RATING:

1.33 at 30 C. amb., 1.0 at 55 C. amb., Average.

## INSULATION CLASS:

0.6 kV. BIL 10kV. full wave.

50-400 Hz.

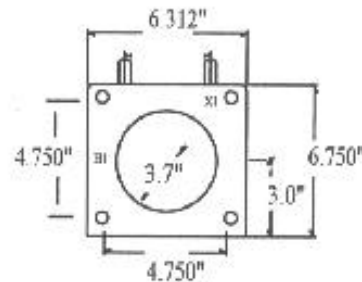
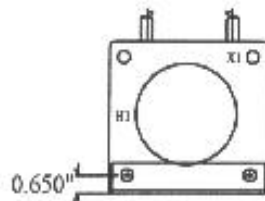
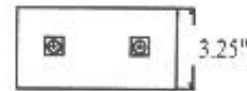
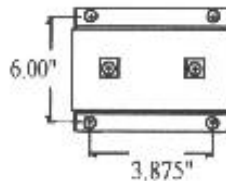
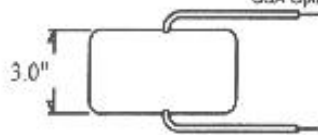

37603RW-\*\*

37603SH-\*\*

- Flexible leads are UL 3134 150 degree C. CSA approved, #12 AWG 24" long.
- Non-Standard length to be specified.
- Terminals are brass No. 10-32 UNC.
- Mounting brackets optional, order No. 37603-MBK.
- Additional ratios available.
- Approximate weight 10 lb.

CATALOG NUMBER	CURRENT RATIO	RELAY CLASS	ANSI METERING CLASS AT 60 Hz				
			B0.1	B0.2	B0.5	B0.9	B1.8
**100	100:5	-	2.4	2.4	-	-	-
**150	150:5	C10	0.6	1.2	2.4	-	-
**200	200:5	C10	0.6	0.6	1.2	2.4	-
**250	250:5	C10	0.3	0.6	1.2	1.2	2.4
**300	300:5	C10	0.3	0.3	0.6	1.2	2.4
**400	400:5	C20	0.3	0.3	0.3	0.6	1.2
**500	500:5	C20	0.3	0.3	0.3	0.6	1.2
**600	600:5	C20	0.3	0.3	0.3	0.3	0.6
**750	750:5	C20	0.3	0.3	0.3	0.3	0.3
**800	800:5	C50	0.3	0.3	0.3	0.3	0.3
**1000	1000:5	C50	0.3	0.3	0.3	0.3	0.3
**1200	1200:5	C20	0.3	0.3	0.3	0.3	0.3
**1500	1500:5	C20	0.3	0.3	0.3	0.3	0.3
**1600	1600:5	C20	0.3	0.3	0.3	0.3	0.3
**2000	2000:5	C20	0.3	0.3	0.3	0.3	0.3

similar to ET models 300

Made in the United States of America

# CURRENT TRANSFORMERS

Window diameter 6.250"

## Model 6291 RW & SH

Fully encapsulated.  
Indoor/outdoor applications.

Standard 5-amp secondary.  
Others available.

### APPLICATION:

For Metering, Wattmeters, Ammeters and Relays.

### CONTINUOUS THERMAL RATING:

1.33 at 30 C. amb.; 1.0 at 55 C. amb., Average.

### INSULATION CLASS:

0.6 kV. BIL 10kV. full wave. 50-400 Hz.

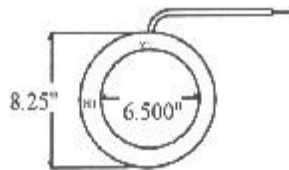
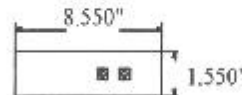
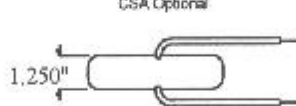

Model 6291RW-\*\*

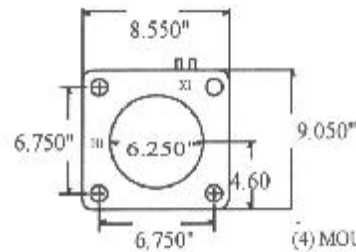

(4) MOUNT HOLES,  
0.328" DIAMETER.

Model 6291SH-\*\*

- Flexible leads are UL 3134 150 degree C. CSA approved, #14 AWG 24" long.
- Non-Standard length to be specified.
- Terminals are brass No. 10-32 UNC.
- Mounting brackets optional, order No. 6291-MBK.
- Approximate weight 4.5 lbs.
- Additional ratios available.

CATALOG NUMBER	CURRENT RATIO	ANSI METERING CLASS AT 60 Hz			
		B0.1	B0.2	B0.5	B0.9
** -600	600:5	0.6	0.6	1.2	-
** -750	750:5	0.6	0.6	0.6	1.2
** -800	800:5	0.3	0.3	0.6	1.2
** -1000	1000:5	0.3	0.3	0.3	1.2
** -1200	1200:5	0.3	0.3	0.3	0.6
** -1500	1500:5	0.3	0.3	0.3	0.3
** -1600	1600:5	0.3	0.3	0.3	0.3
** -2000	2000:5	0.3	0.3	0.3	0.3
** -2500	2500:5	0.3	0.3	0.3	0.3
** -3000	3000:5	0.3	0.3	0.3	0.3
** -3500	3500:5	0.3	0.3	0.3	0.3
** -4000	4000:5	0.3	0.3	0.3	0.3

similar to E175133 models 1-25

Made in the United States of America